

Roll Number

SET A



INDIAN SCHOOL MUSCAT
SECOND TERM EXAMINATION
ENGINEERING GRAPHICS (046)

CLASS: XI

Time Allotted: 2HRS.

02.03.2022

Max. Marks: 35

GENERAL INSTRUCTIONS:

- (i) Attempt all the questions.
- (ii) Use both sides of the drawing sheet, if necessary.
- (iii) All dimensions are in millimeters.
- (iv) Missing and mismatching dimensions, if any, may be suitably assumed.
- (v) Follow the SP: 46 – 2003 revised codes. (with first angle method of projection)
- (vi) Neatness and line work will be duly awarded.

1. A pentagonal pyramid side 25mm and height 50mm rests on HP on its base. One of the edges of the base is perpendicular to VP. A sectional plane perpendicular to VP and inclined at 45° to HP bisects the axis. Draw its sectional top view and front view. 5
2. Draw front view, top view and side view of **any one** of the given blocks. 12

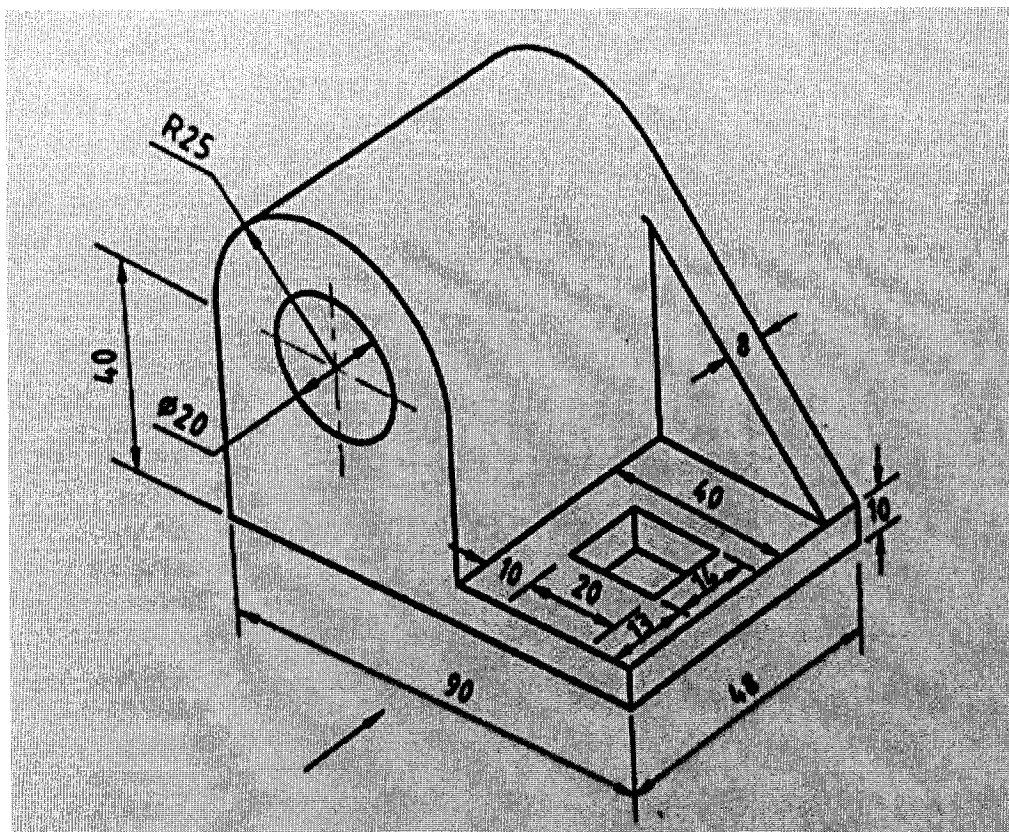

OR

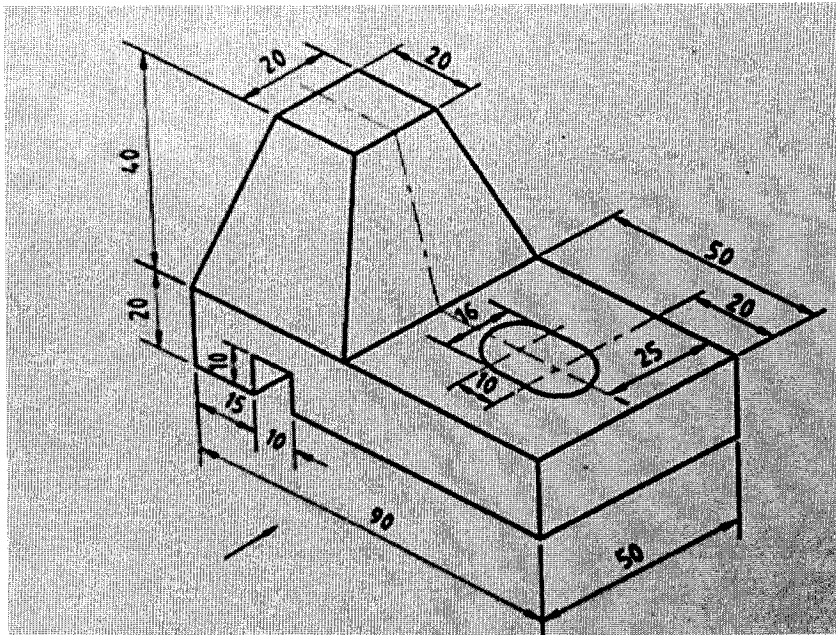

3. Draw front view, top view and side view of the given block.

6

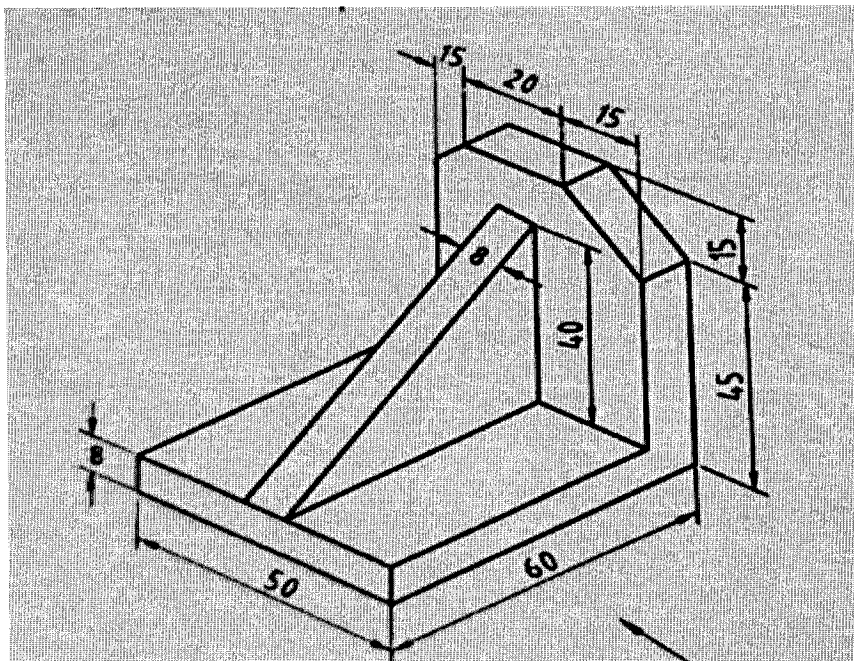

4. Draw an isometric scale. Draw the isometric projection of a hexagonal laminae side 35 mm, in HP, with two of the base sides perpendicular to VP. Mark all dimensions and indicate the direction of view.

12

End of the Question Paper